

TO LET  
**EG**  
EAST GRINSTEAD HOUSE  
WOOD STREET, RH19 1UZ

REFURBISHED OFFICE SUITES, RANGING FROM  
6,162 - 13,987 SQ FT (572.46 - 1,299.42 SQ M)



## location

East Grinstead House is a major office complex located in Wood Street a short distance from East Grinstead Town centre and mainline railway station. Occupiers in the scheme include Capita Symonds, Reed Information and The Caravan Club.

- East Grinstead railway station 400 metres with trains to London Bridge (1 hour) and Victoria (55 mins).
- Junction 6 M25 motorway 7 miles
- Junction 10 M23 motorway 7 miles
- Gatwick Airport 10 miles

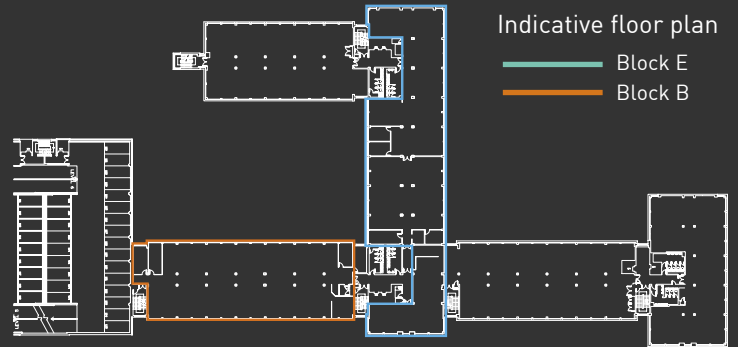

## specification

- Refurbished, open plan, cost effective offices
- Suspended ceilings
- Perimeter Trunking
- 2 X 10 Person passenger lifts
- Male and Female WC's (Disabled WC on ground floor)
- Parking ratio of 1:351 sq ft



## accommodation

|                      | sq ft | sq m   |
|----------------------|-------|--------|
| Second Floor Block B | 6,162 | 572.47 |
| Fourth Floor Block E | 7,825 | 726.96 |

## EPC

The building has an EPC Rating of D (86).

viewing Strictly through the joint sole agents.



Stephen Oliver  
soliver@vailwilliams.com  
T: 01293 575127 M: 07786 577323

James Shillabeer  
jamesshillabeer@brayfoxsmith.com  
T: 020 3362 4351 M: 07824 663594