

FOUNDATION PARK  
MAIDENHEAD

BUILDING 3



FOUNDATION PARK IS A LEADING BUSINESS PARK SET IN THE HEART OF THE THAMES VALLEY AND IS HOME TO SEVERAL HIGH PROFILE COMPANIES.

Maidenhead Railway  
Station / Crossrail

  
London Paddington  
47 min (29.1 miles)

M4  
to M25 /  
Heathrow  
Airport

A404(M)

Cox Green  
Leisure Centre

BUILDING 7

BUILDING 4

BUILDING 5

BUILDING 8

BUILDING 1

  
Reading  
15 min (15.1 miles)

BUILDING 2

BUILDING 3

FOUNDATION PARK OFFERS AN  
ENVIRONMENT DESIGNED AND  
BUILT TO THE HIGHEST QUALITY

**BUILDING 3**

**SHELL AND FLOOR OFFICE  
/ LAB UNIT TO LET**



# BUILDING 3 GROUND FLOOR

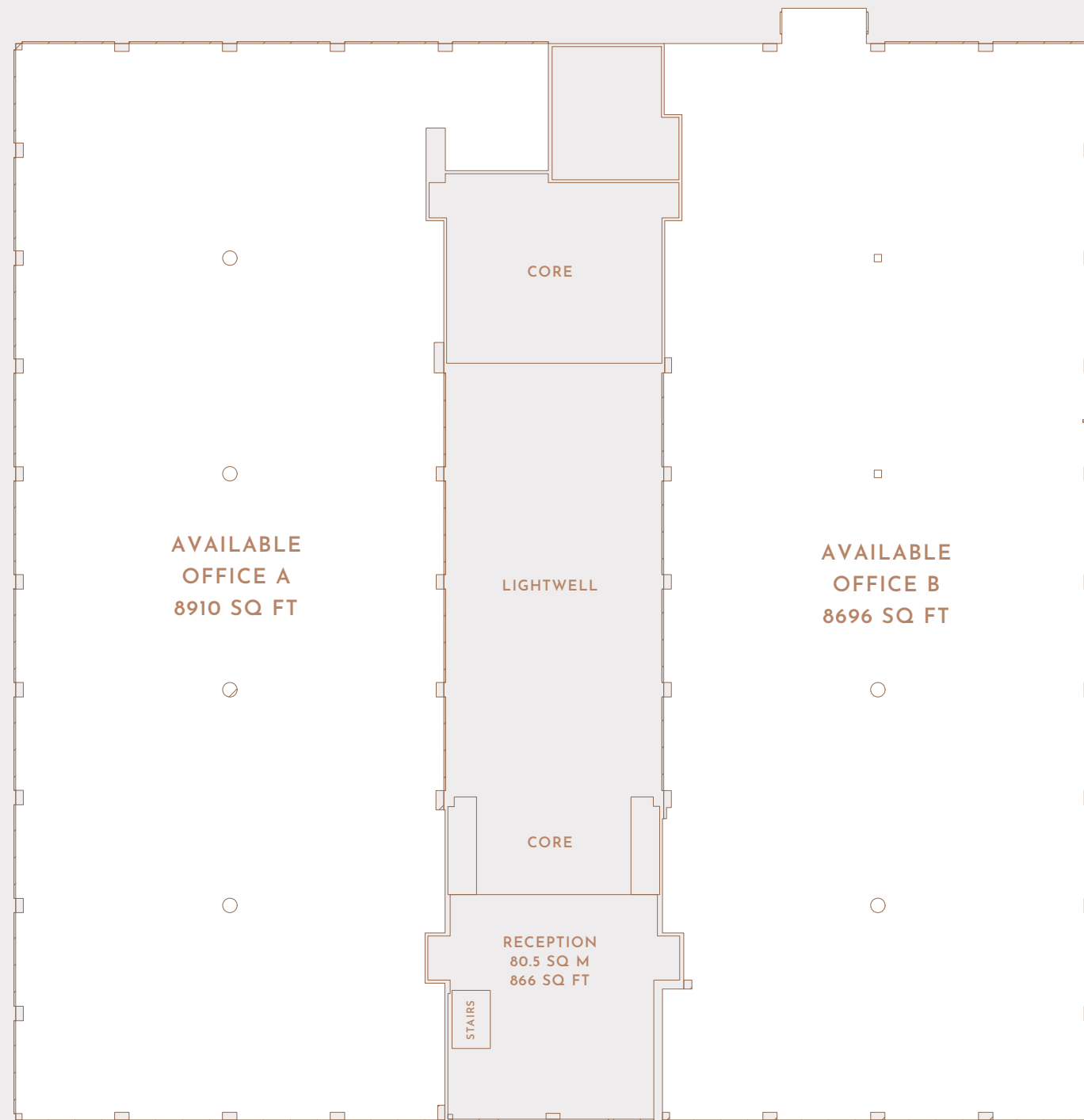

Available to Let  
 Let to AVG

## GROUND FLOOR

**Office A**  
 8910 sq ft available  
 827.8 sq m available

**Office B**  
 8696 sq ft available  
 807.9 sq m available

---

## TOTAL

**18515 sq ft**  
 1720.2 sq m



Buildings 3 - Available to Let

# BUILDING 3 FIRST FLOOR



AVAILABLE  
OFFICE A  
9097 SQ FT

AVAILABLE  
OFFICE B  
8953 SQ FT

Available to Let  
Let

## FIRST FLOOR

**Office A**  
8910 sq ft available  
827.8 sq m available

**Office B**  
8953 sq ft available  
831.8 sq m available

## TOTAL

**18050 sq ft**  
1676.9 sq m

## BUILDING 3

## TOTAL

**36565 sq ft**  
3397.1 sq m



Buildings 3 - Available to Let



**020 7629 5456**

Toby Lumsden  
[tobylumsden@brayfoxsmith.com](mailto:tobylumsden@brayfoxsmith.com)

---

James Shillabeer  
[jameshillabeer@brayfoxsmith.com](mailto:jameshillabeer@brayfoxsmith.com)

---



**020 7935 5000**

Henry Harrison  
[henry.harrison@cushwake.com](mailto:henry.harrison@cushwake.com)

---

James Goodwin  
[james.goodwin@cushwake.com](mailto:james.goodwin@cushwake.com)

---

**FOUNDATIONPARK.CO.UK**

Cushman & Wakefield LLP and Colliers International on its own behalf and for vendors or lessors of this property, whose agent it is, gives notice that: 1. The particulars are produced in good faith, but are a general guide only and do not constitute any part of a contract. 2. No person in the employment of the agent(s) has any authority to make or give any representation or warranty whatsoever in relation to this property. 3. The property is offered subject to contract and unless otherwise stated all rents are quoted exclusive of VAT. 4. Nothing in these particulars should be deemed a statement that the property is in good condition, or that any services or facilities are in working order. 5. Unless otherwise stated, no investigations have been made regarding pollution, or potential land, air or water contamination. Interested parties are advised to carry out their own investigations if required.

July 2023